

Boykin Pastures

Published on Plantation Properties & Land Investments, LLC (<https://landandrivers.com>)



Boykin Pastures

20± acres of fenced pastures located in Screven County, GA. This property is ideal for cattle, farming, horses, hay production, and a home site. Located at the corner of Union Church Rd, Wind Mill Rd and Boykin Rd only 1.5 hours to Augusta, 1 hour to Savannah and 30 min to Statesboro with paved and dirt road frontage. Call Jason Williams today for more information! (912) 764-LAND(5263)



Price: \$100,000

Property Type: Land

Status: Sold

Street/Address: Boykin Rd

City: Sylvania

State: Georgia

Zip code: 30467

County: screven

Acreage: 20

Per Acre Price: \$5,000.00

Phone Number:

Email:

Google Maps link: [View Larger Map](#)

Boykin Pastures

Published on Plantation Properties & Land Investments, LLC (<https://landandrivers.com>)



Aerial Map

Boykin Pastures

Published on Plantation Properties & Land Investments, LLC (<https://landanddrivers.com>)



Soil Map

Boykin Pastures

Published on Plantation Properties & Land Investments, LLC (<https://landanddrivers.com>)

20+/- acres on Boykin Rd., Windmill Rd. & Union Ch Rd.
Screven County, Georgia. 20 AC +/-

PLANTATION PROPERTIES
LAND INVESTMENTS, LLC



Jason Millbank
P. 912-751-LAND (5263) or 1-855-601-LAND (568 5283)

lmj@landanddrivers.com | Landand@earthlink.net

M The information on this website is for informational purposes only and does not constitute an offer of any financial product or service. Please contact your broker for more information.

Topo Map

Boykin Pastures

Published on Plantation Properties & Land Investments, LLC (<https://landanddrivers.com>)

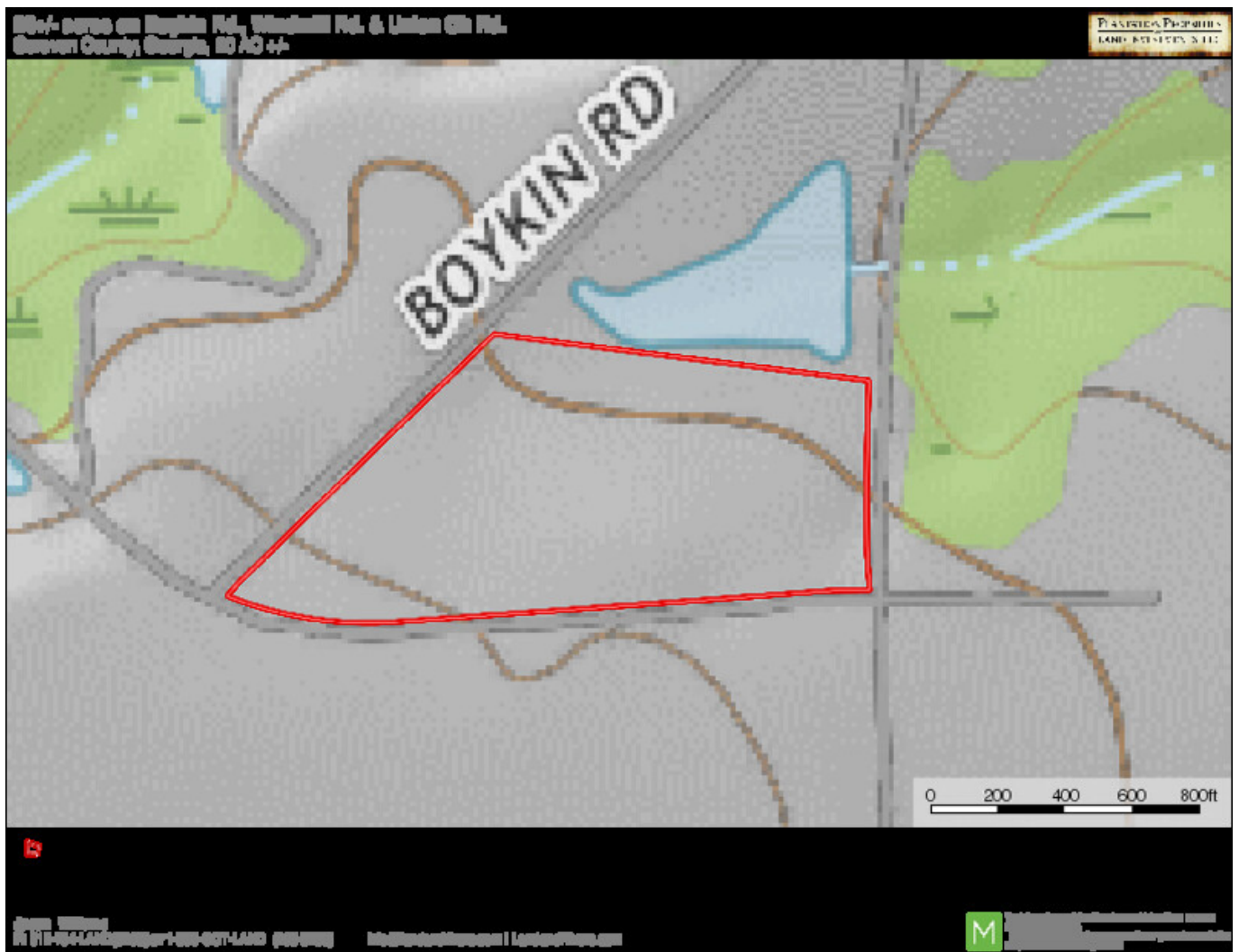

Location Map

Boykin Pastures

Published on Plantation Properties & Land Investments, LLC (<https://landanddrivers.com>)

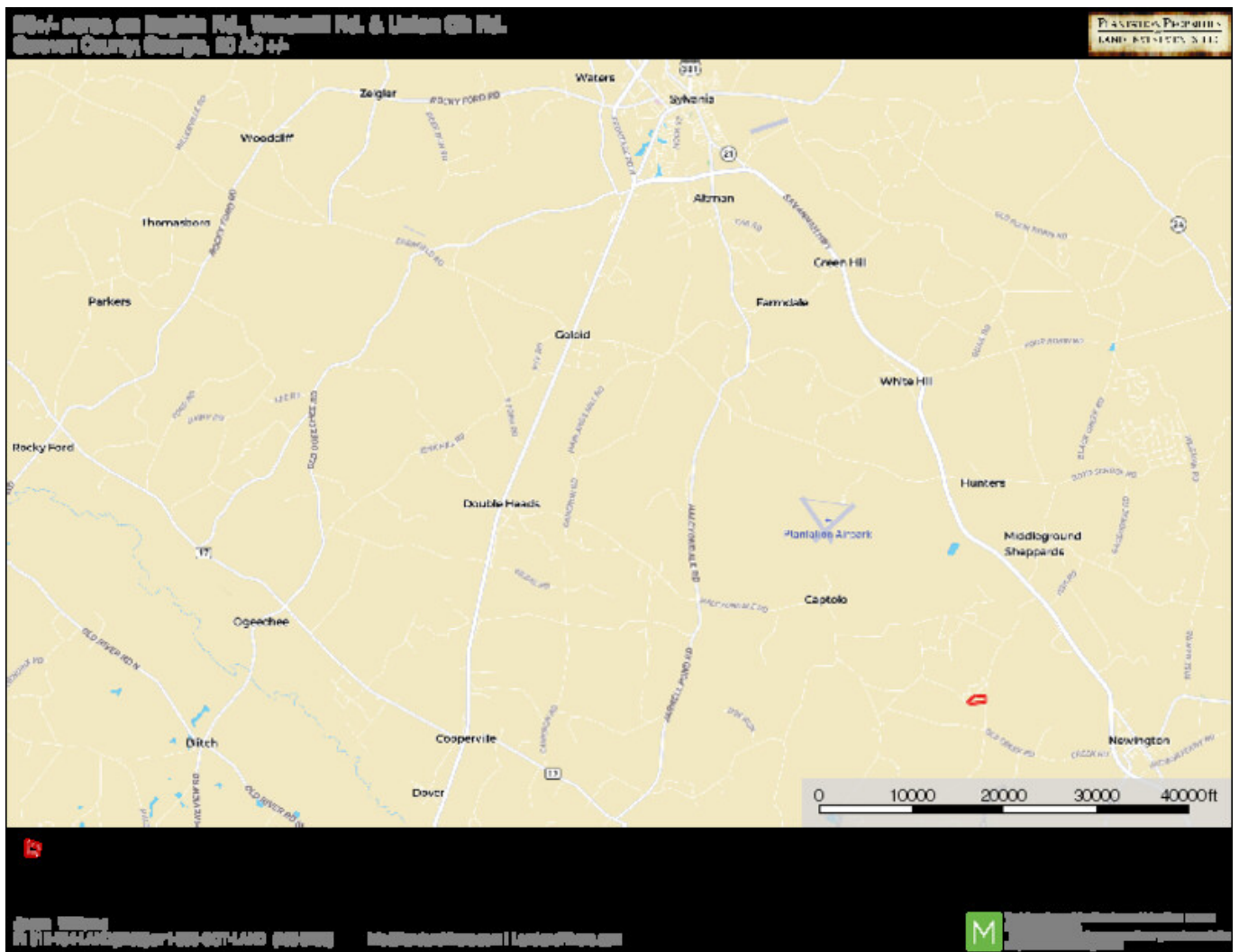

Source URL: <https://landanddrivers.com/property/boykin-pastures>