

Railroad Street - Tract 1

Published on Plantation Properties & Land Investments, LLC (<https://landandrivers.com>)



Railroad Street - Tract 1

Railroad Street Tract 1 is 11± acres in Emanuel County, GA. It is located on S. Railroad St. in Garfield, 5 miles northeast of Twin City and 20 minutes from Swainsboro, with paved road frontage. A mixture of natural hardwood and pine make up the entire tract and Fifteenmile Creek runs along the southern border. This property would be great for a home site or recreational tract. See map for additional acreage available. Call today to schedule a time to view this property!
912.764.LAND(5263)



Price: \$18,700
Property Type: Land
Status: Sold
Street/Address: S. Railroad St.
City: Garfield
State: Georgia
Zip code: 30425
County: emanuel
Acreage: 11
Per Acre Price: \$1,700.00
Phone Number: 912.764.LAND(5263)
Email: info@LandandRivers.com
Google Maps link: [View Larger Map](#)

Aerial Map

Railroad Street - Tract 1

Published on Plantation Properties & Land Investments, LLC (<https://landanddrivers.com>)

S. Railroad St. & Old Garfield Rd.
Emmanuel County, Georgia, AC +/-



Scout24

James Williams
P. 912-764-LAND(5255) or 1-800-GOT-LAND (466-5263)

info@landanddrivers.com | landanddrivers.com

M The information provided on this website is for informational purposes only. It is not intended to constitute an offer of any financial product or service. Please consult your financial advisor for more information.

Topo Map

Railroad Street - Tract 1

Published on Plantation Properties & Land Investments, LLC (<https://landandrivers.com>)



Location Map

Railroad Street - Tract 1

Published on Plantation Properties & Land Investments, LLC (<https://landanddrivers.com>)

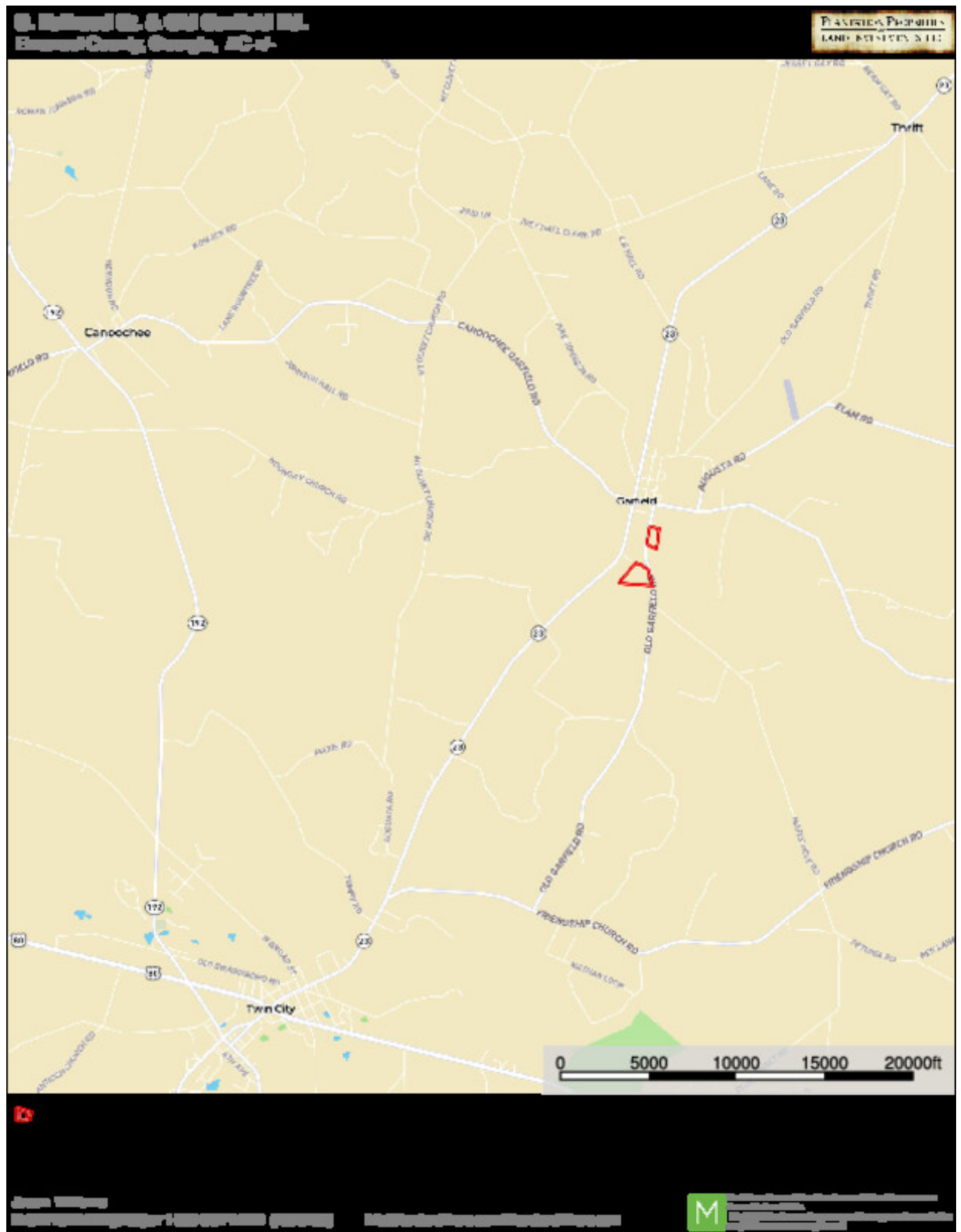

Source URL: <https://landanddrivers.com/property/railroad-street-tract-1>