

Railroad Street - Tract 2

Published on Plantation Properties & Land Investments, LLC (<https://landandrivers.com>)



Railroad Street - Tract 2

Railroad Street Tract 2 is 24± acres in Emanuel County, GA. It is located on S. Railroad St. in Garfield, 5 miles northeast of Twin City and 20 minutes from Swainsboro; and also has paved road frontage on Old Garfield Rd. A mixture of natural hardwood and pine make up the entire tract. This property would be great for a home site or recreational tract. See map for additional acreage available. Call today to schedule a time to view this property! 912.764.LAND(5263)



Price: \$57,600

Property Type: Land

Status: Sold

Street/Address: S. Railroad St.

City: Garfield

State: Georgia

Zip code: 30425

County: emanuel

Acreage: 24

Per Acre Price: \$2,400.00

Phone Number: 912.764.LAND(5263)

Email: info@LandandRivers.com

Google Maps link: [View Larger Map](#)

Railroad Street - Tract 2

Published on Plantation Properties & Land Investments, LLC (<https://landandrivers.com>)



Aerial Map

Railroad Street - Tract 2

Published on Plantation Properties & Land Investments, LLC (<https://landanddrivers.com>)

S. Railroad St. & Old Garfield Rd.
Emmanuel County, Georgia, AC +/-

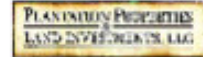

Scout24

James Williams
P. 912-764-LAND(5255) or 1-800-GOT-LAND (466-5283)

info@landanddrivers.com | landanddrivers.com

M The information provided on this website is for informational purposes only. It is not intended to constitute an offer of any financial product or service. Please consult your financial advisor for more information.

Location Map

Railroad Street - Tract 2

Published on Plantation Properties & Land Investments, LLC (<https://landanddrivers.com>)

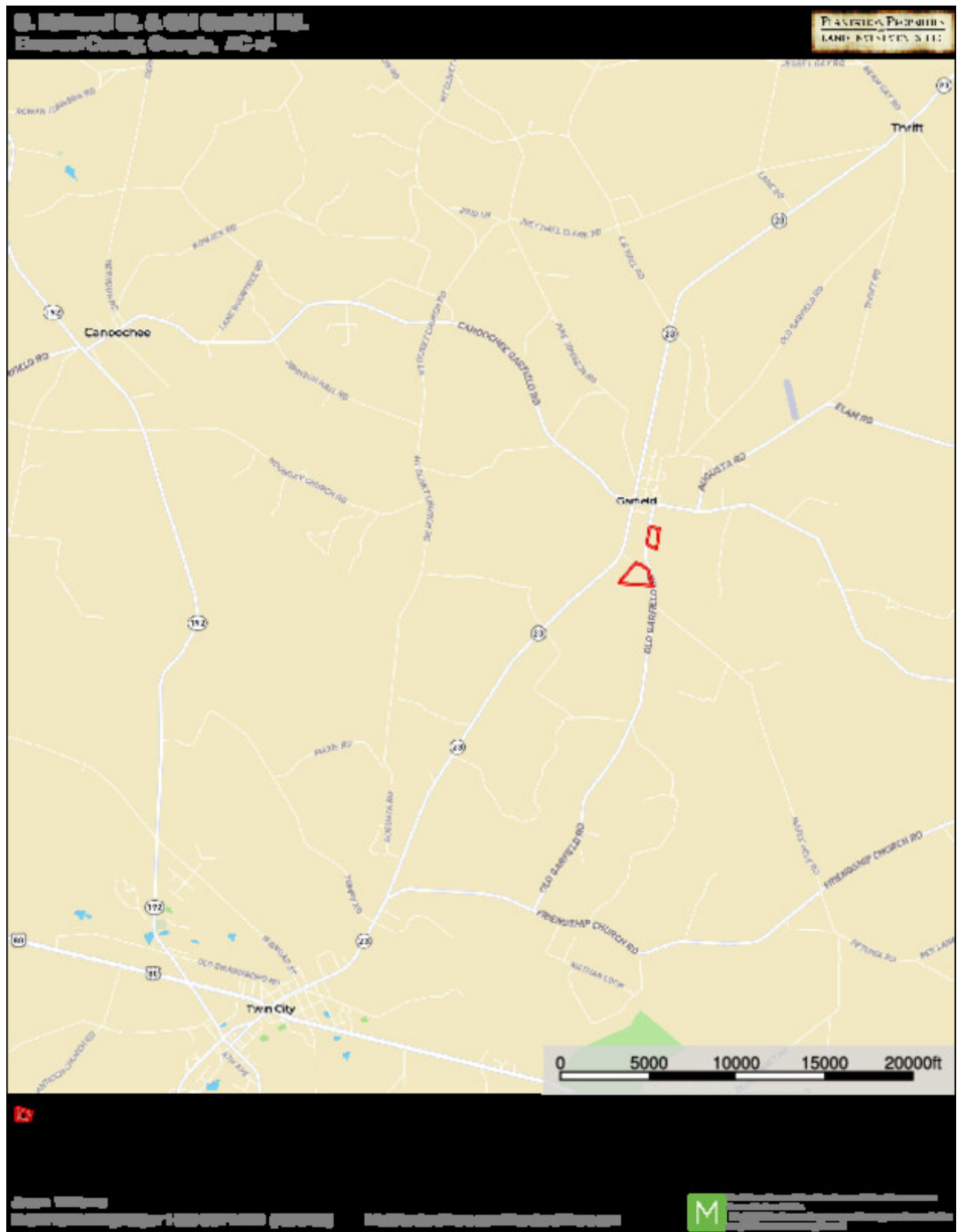

Topo Map

Railroad Street - Tract 2

Published on Plantation Properties & Land Investments, LLC (<https://landanddrivers.com>)



Source URL: <https://landanddrivers.com/property/railroad-street-tract-2>