



## Hudson Ferry Farm

Hudson Ferry Farm is a delightful 68+/- acre southern farm located just outside of Newington, GA in Screven County. A great tract at a great price. This property consists of approximately 45+/- acres of cultivated farm land with a nice hardwood border along the northeast and center of the parcel. The crop fields surrounding the wooded area provide excellent habitat for the wildlife. There are deer and turkey signs everywhere. This farm will make a stunning home place, recreational tract and weekend get-a-way or investment opportunity. Located less than an hour from Savannah, GA and only 25 min from Statesboro, GA. This one is a MUST SEE!!! Call Today to view this property 912.764.LAND(5263)



**Price:** \$122,400

**Property Type:** Land

**Status:** Sold

**Street/Address:** 11351 Newington HWY

**City:** Newington

**State:** Georgia

**Zip code:** 30446

**County:** screven

**Acreage:** 68

**Per Acre Price:** \$1,800.00

**Phone Number:** 912.764.LAND(5263)

**Email:** [jasonwilliams@landandrivers.com](mailto:jasonwilliams@landandrivers.com)

**Google Maps link:** [View Larger Map](#)

## Aerial Map



**PLANTATION PROPERTIES  
&  
LAND INVESTMENTS, LLC**

12072 Sheppard's Way, Suite 101, Suwanee, GA 30066  
770.764.1400 (5263) | 770.726.3630

Jason Williams

This document is not to be distributed or duplicated

[www.landandrivers.com](https://landandrivers.com)

© 2022

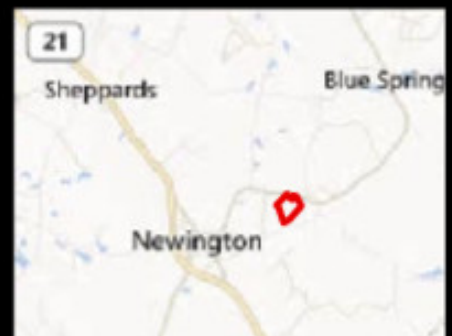

## Hudson Ferry Farm

Published on Plantation Properties & Land Investments, LLC (<https://landandrivers.com>)

## Location Map

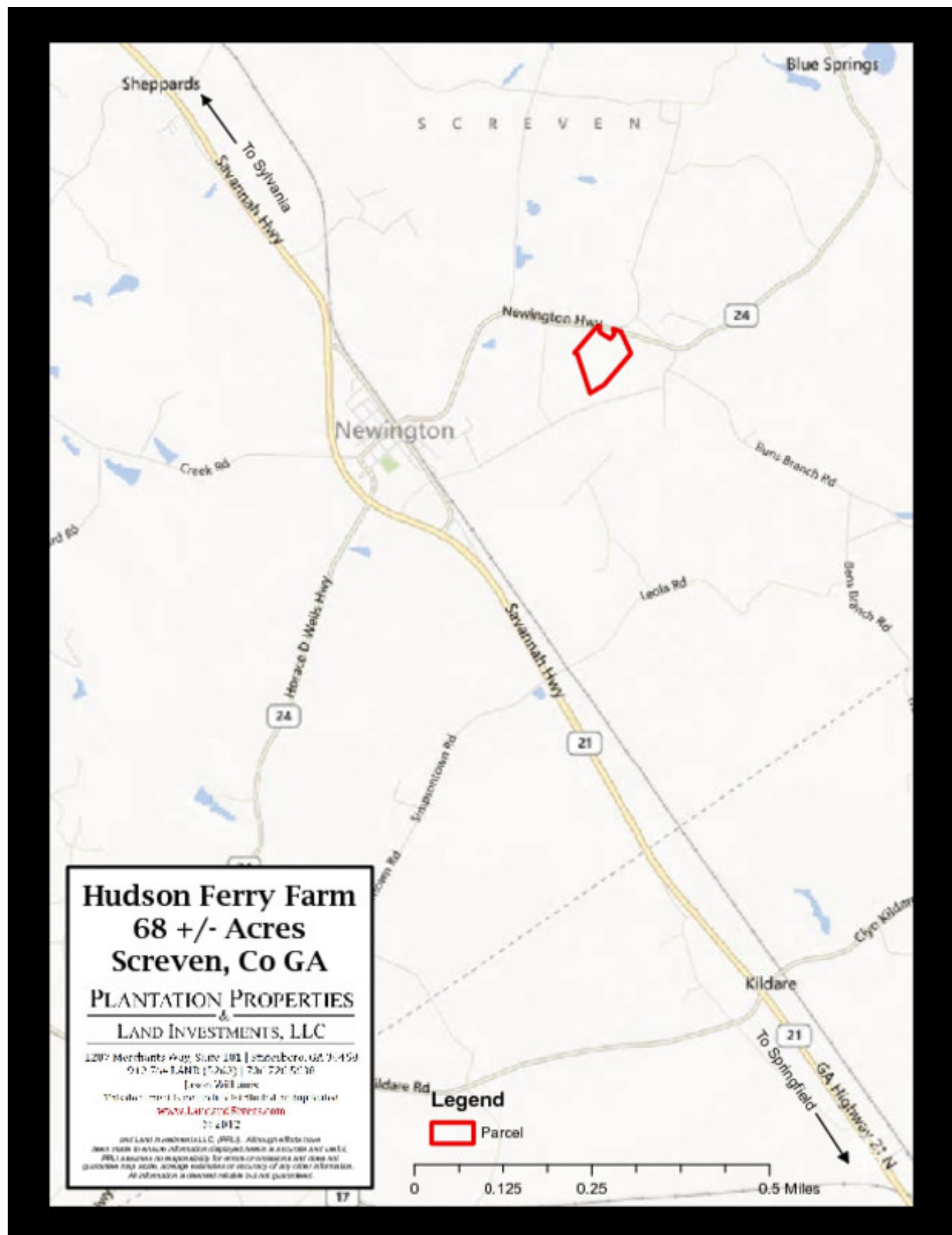

## Topo Map



**PLANTATION PROPERTIES  
&  
LAND INVESTMENTS, LLC**

12072 Sandcastle Way, Suite 101, Suwanee, GA 30086  
770.764.1400 (5263) | 770.726.3630

Jason Williams

This document is not to be distributed or duplicated

[without written permission](https://landanddrivers.com)

© 2023

