

FLOOD ZONE NOTE

ACCORDING TO F.J.R.M. MAP NO. 13031C0205D, WITH AN EFFECTIVE REVISED DATE OF 8/5/2010, THIS PROPERTY LIES WITHIN ZONE "X". ZONE "X" IS NOT A SPECIAL FLOOD HAZARD ZONE INUNDATED BY THE 100-YR. FLOOD.

WETLANDS NOTE:

"ALL TIDAL AND NON-TIDAL TRIBUTARIES, MARSH AREAS AND WETLANDS ARE UNDER THE JURISDICTION OF THE CORPS OF ENGINEERS AND/OR THE STATE OF GEORGIA DEPARTMENT OF NATURAL RESOURCES. OWNERS ARE SUBJECT TO PENALTY BY LAW FOR DISTURBANCE OF THESE PROTECTED AREAS WITHOUT PROPER PERMIT APPLICATION AND APPROVAL FROM THOSE AGENCIES." NO WETLANDS WERE DELINEATED AT THE TIME OF THIS SURVEY.

GRAPHIC SCALE

1" = 100'

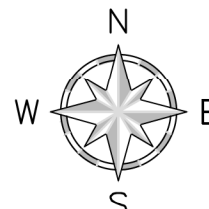
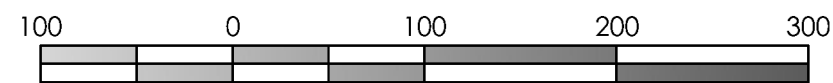

GRID NORTH
GA. EAST ZONE

SITE INFORMATION

SITE CONTAINS A PORTION OF PARCEL 075 000006 000. PROPERTY ID NUMBERS WERE TAKEN FROM THE BULLOCH COUNTY TAX ASSESSOR.

STREET ADDRESSES: 1026 EMIT DEAL RD

ADJOINING PARCEL INFORMATION WAS TAKEN FROM THE BULLOCH COUNTY TAX ASSESSOR WEBSITE.

LEGEND

- RBF = REBAR FOUND
- BRBF = BENT REBAR FOUND
- CRBS = CAPPED REBAR SET
- CMF = CONCRETE MARKER FOUND
- BCMF = BROKEN CMF
- IPF = IRON PIPE FOUND
- PP = POWER POLE
- P/L = PROPERTY LINE

REFERENCES

DEED BOOK 829, PAGE 288
PLAT BOOK 52, PAGE 107
PLAT BOOK 52, PAGE 147

CASEY R. CYRUS &
CHELSEA C. CYRUS
DEED BOOK 2538, PAGE 056
PLAT BOOK 52, PAGE 149
TAX ID# 075 000003A 002

KENNY J. ANDERSON &
DIANNE A. ANDERSON
DEED BOOK 827, PAGE 145
PLAT BOOK 52, PAGE 125
TAX ID# 075 000003A 003

SHERRI JO AKINS
DEED BOOK 2385, PAGE 179
PLAT BOOK 52, PAGE 125
TAX ID# 075 000003A 003

JILL B. BOYKIN
DEED BOOK 1953, PAGE 485
PLAT BOOK 34, PAGE 31
DEED BOOK 2604, PAGE 793
PLAT BOOK 68, PAGE 322
TAX ID# 075 000004 000

STEPHEN F. GAY & JACKIE H. GAY
DEED BOOK 829, PAGE 288
PLAT BOOK 52, PAGE 147
TAX ID# 075 000006 000

JOSHUA ADAM FINCHER
& MIRANDA FINCHER
DEED BOOK 2475, PAGE 731
PLAT BOOK 52, PAGE 107
TAX ID# 075 000006 001

**10.00 ACRES
(VACANT)**

CERTIFICATE OF APPROVAL FOR RECORDING

THE FOLLOWING GOVERNMENTAL OFFICIAL HAS APPROVED THIS PLAT FOR FILING.

ZONING ADMINISTRATOR _____ Date _____

TREVOR & ALEXANDRA WEATHERSBY
DEED BOOK 2562, PAGE 306
PLAT BOOK 62, PAGE 177
TAX ID# 060 000033 004



ENGINEERING &
LAND SURVEYING
40 JOE KENNEDY BLVD.
STATESBORO, GA 30458
(912) 489-7112 OFFICE
(912) 489-7125 FAX

11605 HAYNES BRIDGE
RD. SUITE 475
ALPHARETTA, GA 30009
(404) 693-1618 OFFICE

SURVEYOR CERTIFICATIONS

As required by subsection (d) of O.C.G.A. Section 15-6-67, this plat has been prepared by a land surveyor and approved by all applicable local jurisdictions for recording as evidenced by approval certifications, signatures, stamps, or statements hereon. Such approvals or affirmations should be confirmed with the appropriate governmental bodies by any purchaser or user of this plat as to intended use of any parcel. Furthermore, the undersigned land surveyor certifies that this plat complies with the minimum technical standards for property surveys in Georgia as set forth in the rules and regulations of the Georgia Board of Registration for Professional Engineers and Land Surveyors and as set forth in O.C.G.A. Section 15-6-67.

John A. Dotson - GA. RLS #2500

11/30/2020
Date

CERTIFICATE OF
AUTHORIZATION # LSF000953

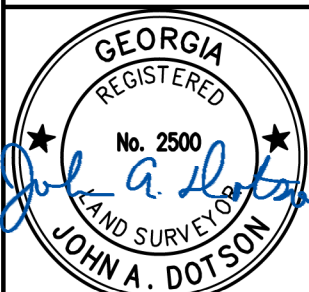

PRECISION DATA
E.O.C. FIELD 1/48.665
ERROR PER ANGLE 00°00'01.5"
ADJ. METHOD NETWORK LEAST SQUARES
E.O.C. PLAT 1/790.970

FIELD EQUIPMENT
TRIMBLE R6 GPS
MAGNETIC LOCATOR
TRIMBLE ACCESS
TRIMBLE SB

DRAWN BY: JTD
FIELD WORK: 11-14-2020
DATE: 11-30-2020
JOB NO.: 2019-255
SCALE: 1" = 100'

BOUNDARY SURVEY OF 10.00 ACRES
CREATED FROM PARENT TRACT
PREPARED FOR
STEPHEN F. & JACKIE H. GAY
LOCATED IN THE 1209TH G.M.D.
BULLOCH COUNTY, GA